

REV	DESCRIPTION	DRAWN	CHECKED	APPROVED
A	NEW RELEASE	ZQJ 11/18/2014	~	ZQJ 11/18/2014
B	ADD P/N CODE	CJJ 11/18/2014	~	

NOTES:

1. SPECIFICATION
 - 1.1 TEMPERATURE: -40° to +105°C.
 - 1.2 DIELECTRIC WITHSTANDING VOLTAGE: AC 500V AC.
 - 1.3 INSULATION RESISTANCE: 1000MΩ
 - 1.4 CURRENT RATING: 3Amps.
 - 1.5 CONTACT RESISTANCE: 30mΩ,max.

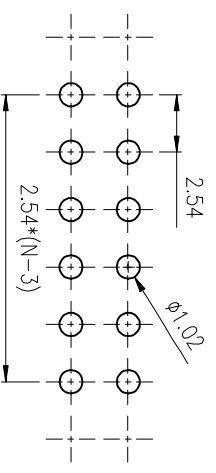
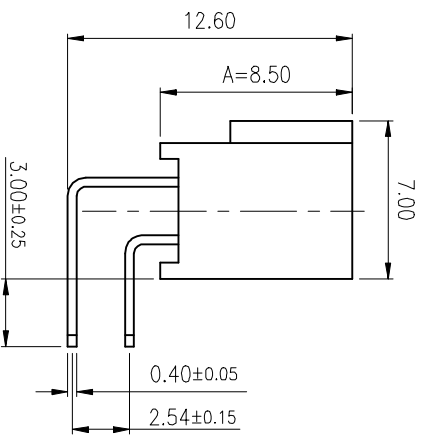
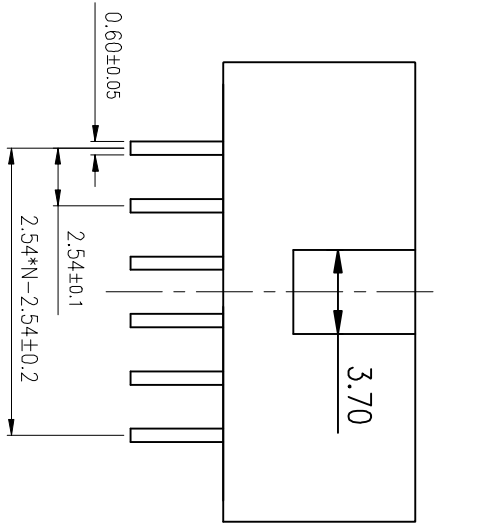
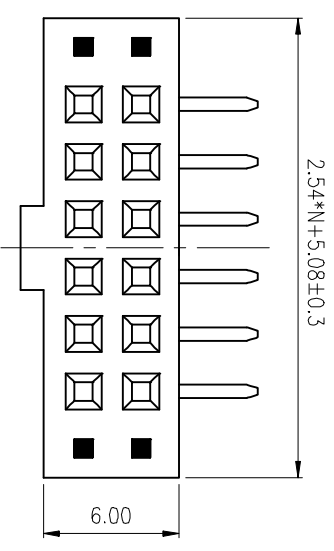

RECOMMAND PCB LAYOUT(TOLERANCE=±0.05)

GENERAL TOLERANCE		ANGLE	TOLERANCE
X.	±0.60	X.	±5°
.X	±0.38	.X	±3°
.XX	±0.25	.XX	±2°

DRAWING TYPE	CUSTOMER	SHEET	1 OF 1
SCALE	1:1	SHEET	1 OF 1
DRAWING NO.			

PROJECTION	TITLE
UNITS	2.54mm FEMALE HEADER
SHEET SIZE	FOR "BOX HEADER" MATING
A4	SERIES
LL1015-2C	



慈溪蓝翎电子有限公司
CIXI LANLING ELECTRONICS CO., LTD.